

WARNING:

- * Please DO cut off power to avoid electric shock and endanger life safety before installation
- * Installation height should be higher than 1.2m.
- * For pole mounting, please complete wiring at the accessible hand-hole on the pole.

Installation Instruction

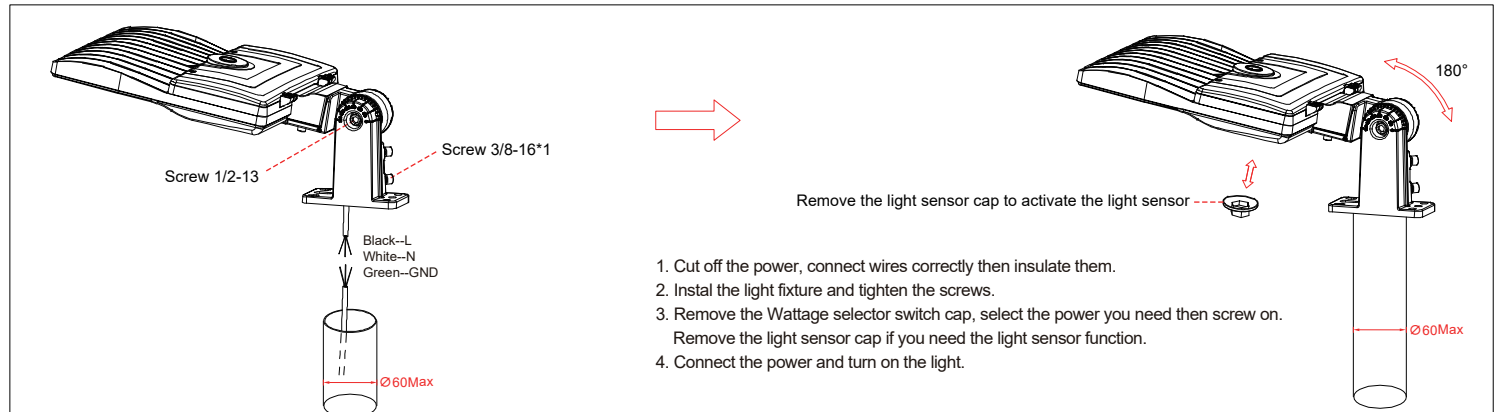

1. Cut off the power, connect wires correctly then insulate them.
2. Install the light fixture and tighten the screws.
3. Remove the Wattage selector switch cap, select the power you need then screw on.
Remove the light sensor cap if you need the light sensor function.
4. Connect the power and turn on the light.

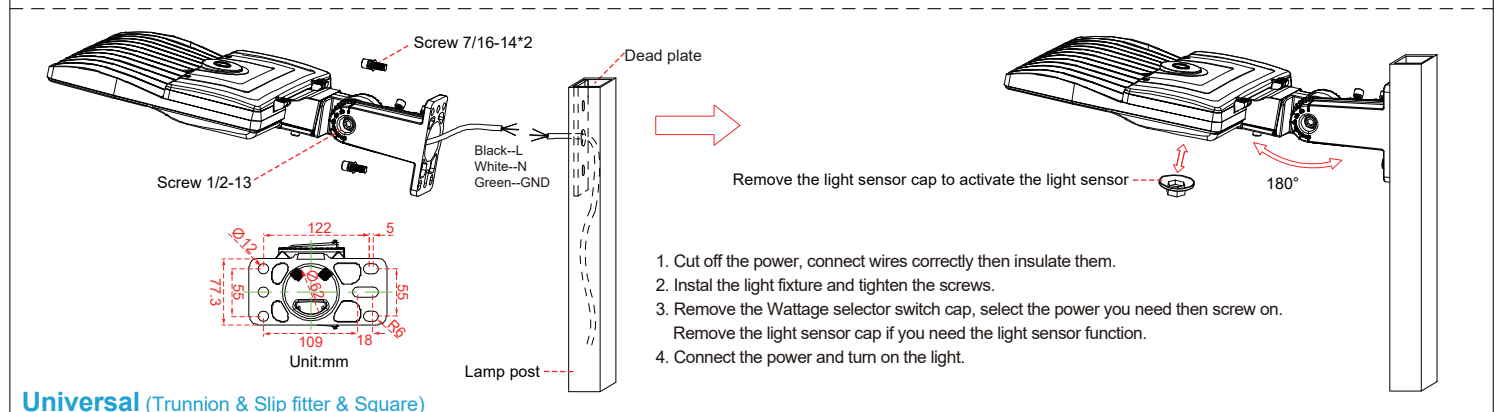

1. Cut off the power, connect wires correctly then insulate them.
2. Install the light fixture and tighten the screws.
3. Remove the Wattage selector switch cap, select the power you need then screw on.
Remove the light sensor cap if you need the light sensor function.
4. Connect the power and turn on the light.

Universal (Trunion & Slip fitter & Square)

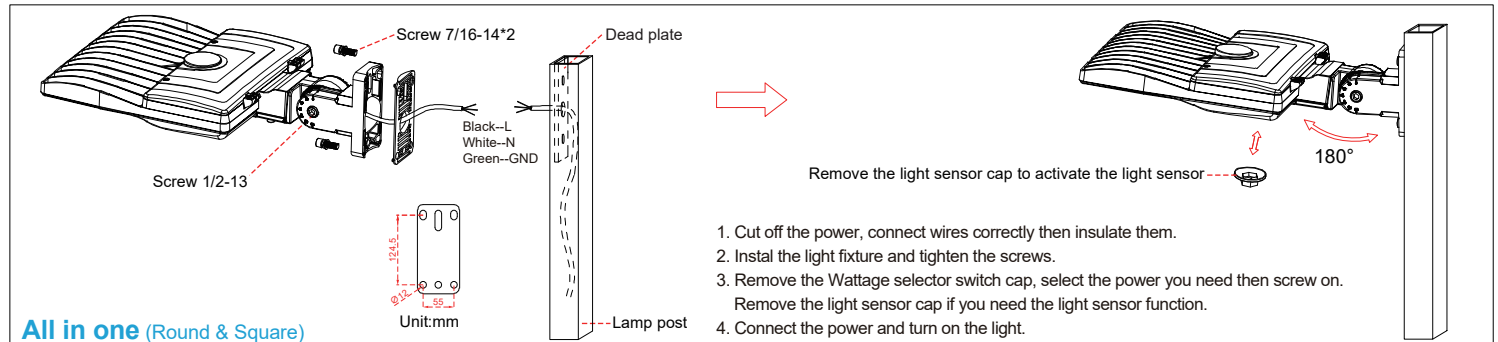

1. Cut off the power, connect wires correctly then insulate them.
2. Install the light fixture and tighten the screws.
3. Remove the Wattage selector switch cap, select the power you need then screw on.
Remove the light sensor cap if you need the light sensor function.
4. Connect the power and turn on the light.

All in one (Round & Square)

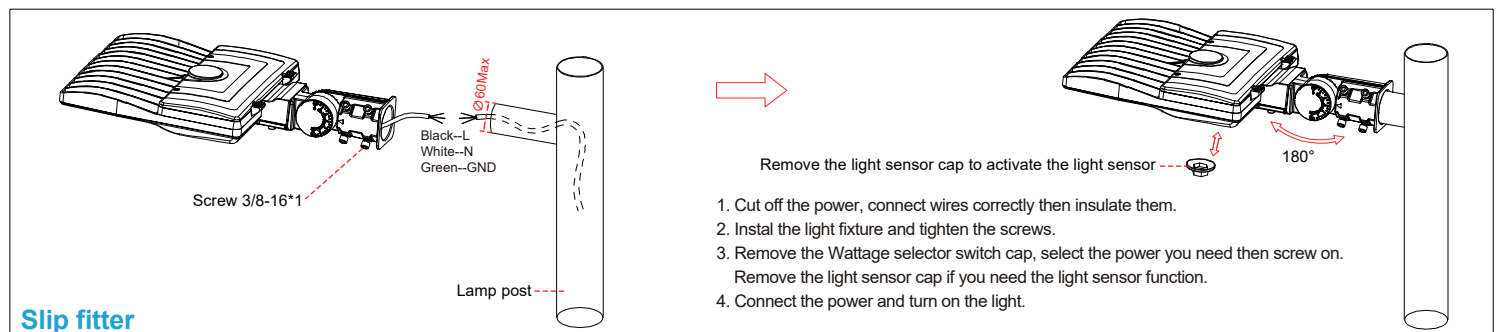

1. Cut off the power, connect wires correctly then insulate them.
2. Install the light fixture and tighten the screws.
3. Remove the Wattage selector switch cap, select the power you need then screw on.
Remove the light sensor cap if you need the light sensor function.
4. Connect the power and turn on the light.

Slip fitter

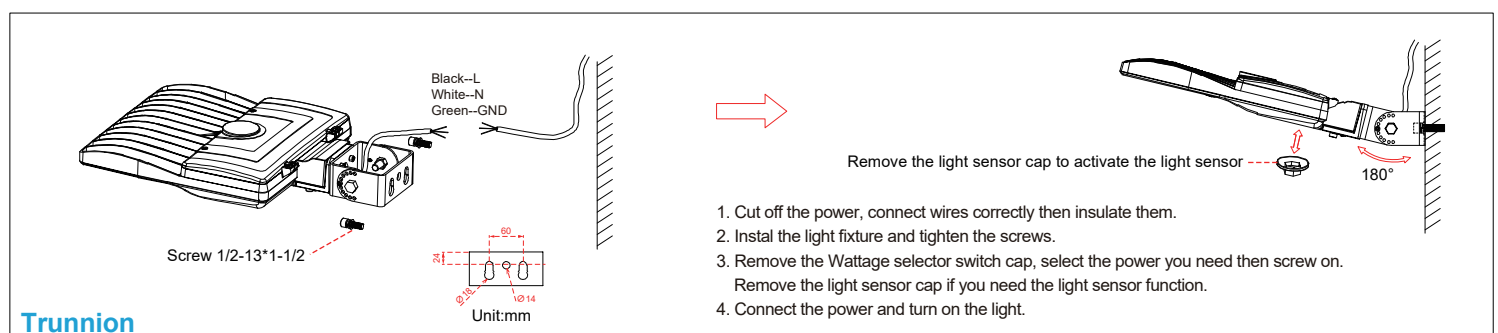

1. Cut off the power, connect wires correctly then insulate them.
2. Install the light fixture and tighten the screws.
3. Remove the Wattage selector switch cap, select the power you need then screw on.
Remove the light sensor cap if you need the light sensor function.
4. Connect the power and turn on the light.

Trunion

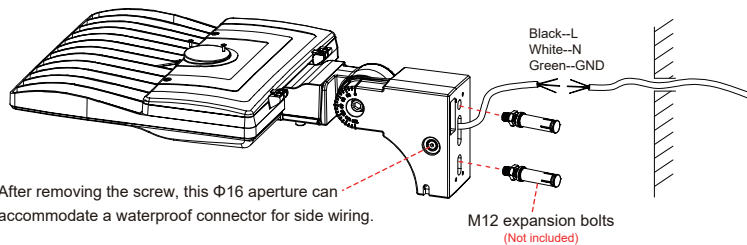

After removing the screw, this Φ16 aperture can accommodate a waterproof connector for side wiring.

1. Cut off power. Connect the fixture to the mains electricity supply and ensure proper insulation.
2. Drill M12 expansion bolts into the wall. Open the square round cover plate. Install the fixture onto the wall and tighten the nuts.
3. Reinstall the bracket cover plate and tighten the screws.
4. Twist open the power adjustment screw plug and adjust to the desired power level. If a light sensor is required, remove the light sensor cover.
5. Turn on the mains power switch to power on the fixture.

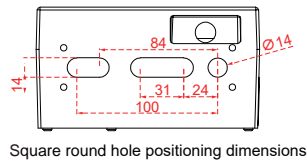

Square round hole positioning dimensions

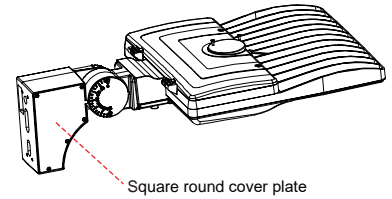
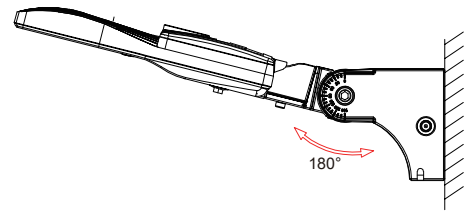

Square round cover plate

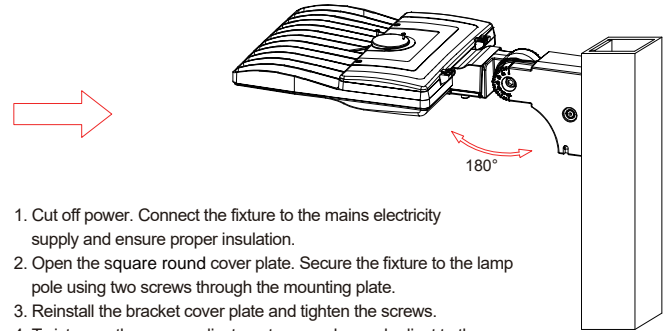
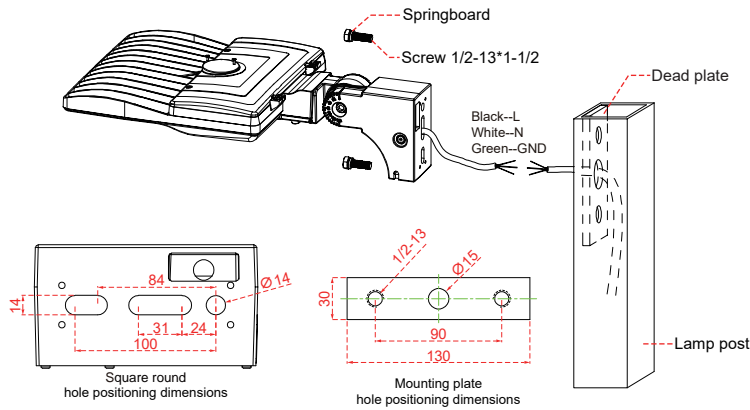

1. Cut off power. Connect the fixture to the mains electricity supply and ensure proper insulation.
2. Open the square round cover plate. Secure the fixture to the lamp pole using two screws through the mounting plate.
3. Reinstall the bracket cover plate and tighten the screws.
4. Twist open the power adjustment screw plug and adjust to the desired power level. If a light sensor is required, remove the light sensor cover.
5. Turn on the mains power switch to power on the fixture.

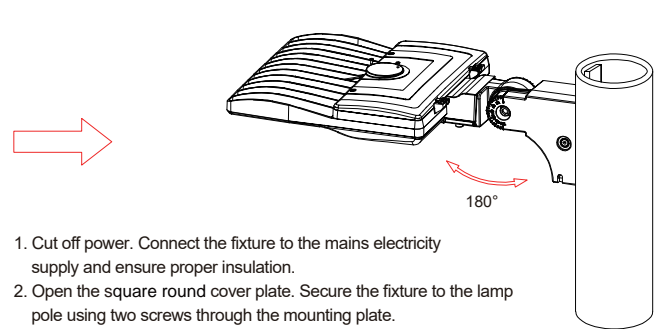
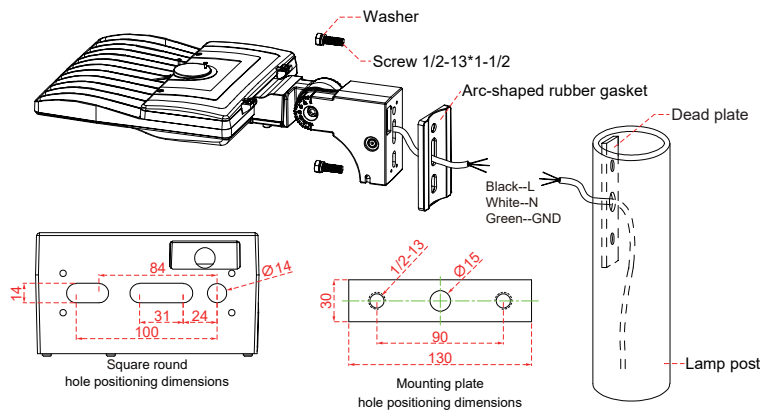

1. Cut off power. Connect the fixture to the mains electricity supply and ensure proper insulation.
2. Open the square round cover plate. Secure the fixture to the lamp pole using two screws through the mounting plate.
3. Reinstall the bracket cover plate and tighten the screws.
4. Twist open the power adjustment screw plug and adjust to the desired power level. If a light sensor is required, remove the light sensor cover.
5. Turn on the mains power switch to power on the fixture.

Square Round

Power Selections:

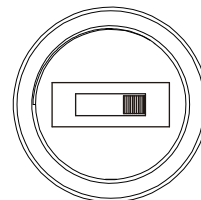
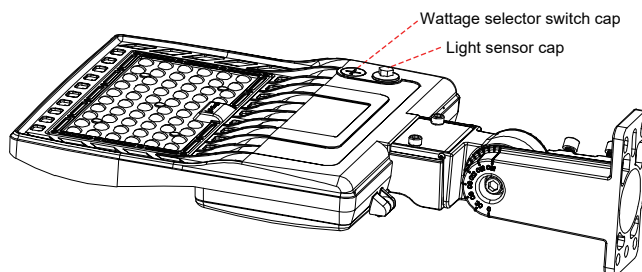

Wattage Selector Switch

From left to right, light power increases gradually

	NSB-100W	NSB-150W	NSB-200W	NSB-240W	NSB-320W	NSB-400W	NSB-450W
L	60W	90W	120W	144W	192W	240W	270W
M	80W	120W	160W	192W	256W	320W	360W
H	100W	150W	200W	240W	320W	400W	450W

There are power options(L/M/H),please select the power according to your needs.

*** WARNING:** Turn off the lamp when adjusting the power to avoid damage to the lamp.